

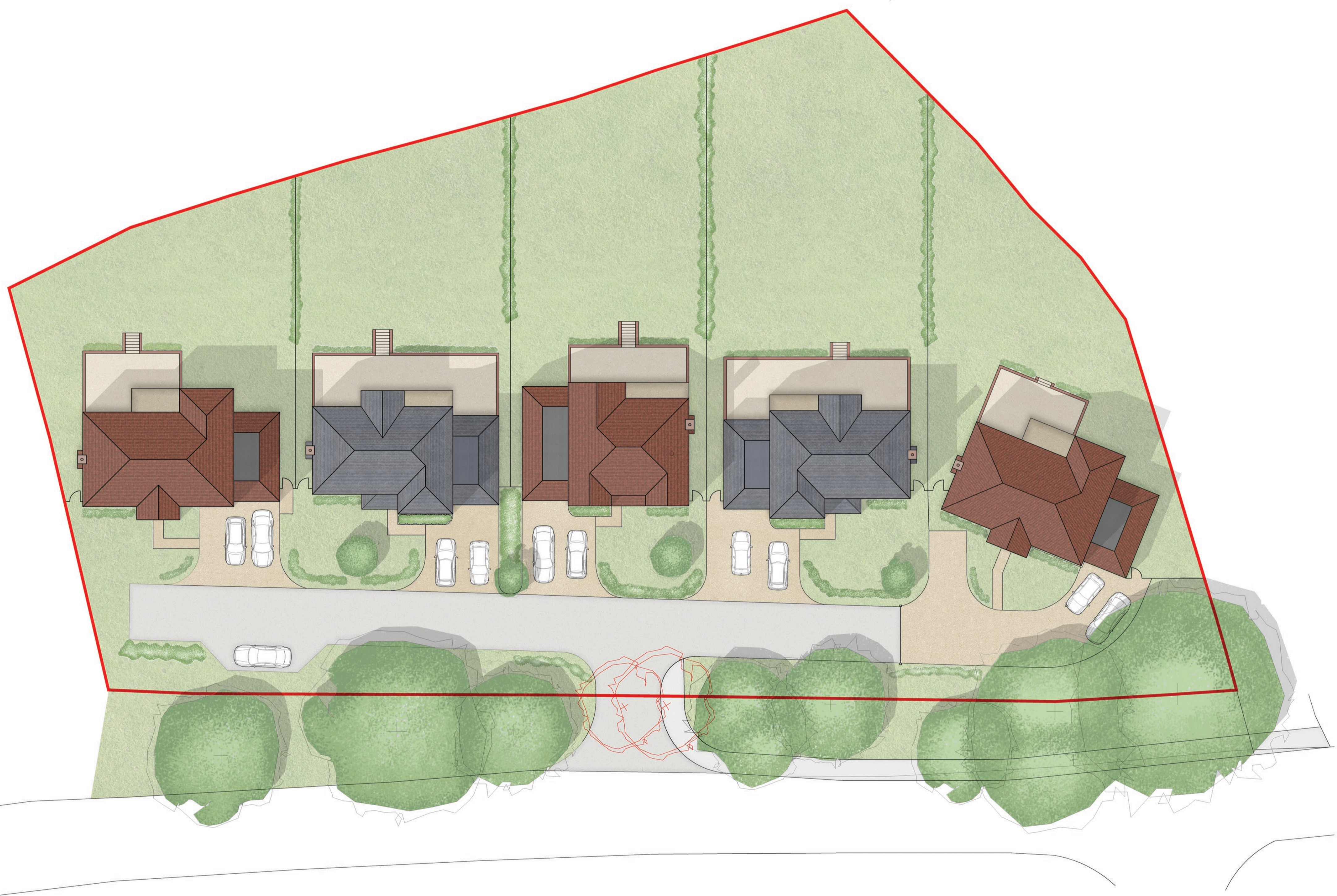

AMENDED



C	Road width reduced locally to 6.2m. Plot 1 parking arrangement reorganised. Plot 1 handed. Trees removed. Site layout and street scene amended to suit. Path added along road. Plot 5 double garage replaced with a single garage.	JB	02/03/20
B	Plot 1 handed and Plot 5 single garage replaced with a double garage. Site layout and street scene amended to suit.	JB	27/11/19
A	Plots 1 & 5 garages attached to the dwellings following comments from the planning officer, site layout and street scene amended to suit.	MM	11/11/19

FOR DISCUSSION

Do not scale from this drawing. ALL RELEVANT DIMENSIONS AND LEVELS TO BE ASCERTAINED OR CHECKED AND VERIFIED ON SITE BEFORE SPECIFIC AREAS OF WORK ARE COMMENCED.

All errors or discrepancies must be reported to the designer or contract administrator immediately on discovery.

This drawing remains the sole copyright of KENT DESIGN PARTNERSHIP until such time as an assignable licence is granted.

All materials, workmanship and components must comply with the relevant British Standards, Codes of Practice and any manufacturer Instructions.

Contractors should make themselves aware of accredited details and use as appropriate to ensure continuity of insulation and air barrier. Any divergence from accredited details should be noted and continuity of insulation and air barrier maintained. Note:- (not all positions marked similar positions should use Accredited Detail. Check with Contract Administrator, Designer or Architect if in doubt!)

All work to be to the entire satisfaction of the NHBC or Local Authority not withstanding anything shown or indicated on these drawings. All workmanship and materials to be the best of their respective kind and at least equivalent of the appropriate British Standard Code of Practice. Damp proof courses and membranes to be built into new works in strict accordance with accepted building practice. All parties must check the drawings to ensure that the adequacy and suitability of weatherproofing details are satisfactory for the site conditions.

**DANEDALE STABLES
CHEQUERS ROAD
MINSTER**

MR R STED-SMITH

STREET SCENE AND SITE LAYOUT

Drawn By	Checked By	Date	Scale	Size	Revision
MM	JB	02/11/19	1:200	A1	C

Drawing Number
19.37_PL20



KENT DESIGN PARTNERSHIP
Grove Dairy Farm Business Centre,
Bobbing Hill, Sittingbourne, Kent ME9 8NY
Telephone : 01795 844162.
e-mail : mail@kdp-architect.co.uk
Web : www.kdp-architect.co.uk